

Mini Magic

Introduction

Mini Magic is a new portable PEMF device designed to reduce pain and discomfort anywhere, anytime.

A small blessing to people suffering from acute pain. Discrete, stylish, and easy to use. Mini Magic can be used daily with confidence. If you can flick a switch, you can use Mini Magic. Don't live your life in unnecessary pain. The Mini Magic will become your miracle mate, providing support when you most need it.

Warning

Never use Mini Magic in, near, or around water. Mini Magic's powerful magnetic pulses also prohibit its use under the following circumstances:

During Pregnancy

When using a Non-MRI-Safe IUD

People or Animals with Organ Transplants

People or Animals with Pacemakers, Hearing Aids, Medical Pumps, or other Electrical Implants/Devices

NOTE

Non-magnetic metal rods, screws, and plates are safe for PEMF use. If an implant is safe for an MRI, it is safe to use Mini Magic.

Parcel Contents

Your parcel contains one wrist band (big) and two boxes: One small and the other one larger:



The small box

contains a 5V power adapter, USB power cable, and wrist band (small).



The larger box

has two layers. On the top is the main unit. Under this is a pair of single coils, velvet bag, and coil tester.



Power Supply Options

There are three options to supply power to Mini Magic: 9v battery, portable power supply, or mains power (using the 5v power adapter). The first two options grant you freedom to move during treatments.

1 . If you choose to use a 9v battery, we suggest you using a lithium battery. The battery compartment is accessed by gently pressing this tab:



- The lid can then be gently lifted off.



- The battery is inserted into the battery compartment as shown in this photo. It is important to have the battery orientated correctly, with the positive terminal on the right-hand side.

3

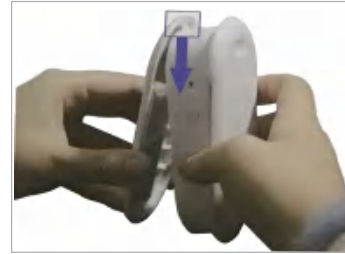

- Position the lid so the top is held by a tab on the main unit, and gently click the lid shut. Do not use excessive force.

2 . The USB Power Cable can be connected to a portable power supply. This provides longer treatment durations.



4

3 . The same USB Power Cable can also be used with the 5V power adapter.



- You can choose the power option that best suits your needs.

Tips: When you use the portable power supply or mains power, please take the battery out. If you leave the battery inside, it will take power from the battery first.

Coil Connection

The next step is to plug the coil into Mini Magic. Make sure the coil plug is fully inserted into the socket.

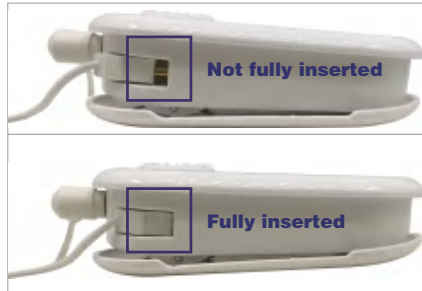

5



- You can set the desired power level using the 3-position rotary switch. Level three is the one we recommend. If you are sensitive, you can select a lower power level.



- Turn on Mini Magic using the switch located on the right.

Coil Placement

There are two sides for the coils; one side is smooth, and the other is bumpy. The coils must always have the smooth side touching your skin.

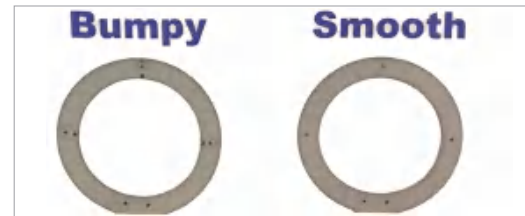

6

Coil Positioning

There are three different options for positioning the coils. Here we show some examples for treating the wrist.



1. Side by side

The first option is to have the coils side by side. This increases the area being treated, but the treatment depth is shallow.



2. Across treatment area

The second option is to have the coils across the treatment area, so the coils face each other. This is our recommended option for most situations. In this way, every part between the coils will be treated.



3. Stacked

The third option is to stack them on top of each other. The bumps of the coils must face each other. This option is similar to placing the coils side by side, but the depth is increased.

Similar coil positioning can be used for other body areas. It is ok to do it over clothing as long as the clothes are not too thick.





- Please make sure the shirt button does not contain metal.

Coil Testing

The coils make a tiny ticking sound when they are placed on top of each other. This can be difficult to hear, so we provide a Coil Tester. Place the coils individually on top of the Coil Tester. The red lights should flash regularly during operation.



Big Magic

Introduction

Big Magic is called "Magic" for good reason; regular use will produce truly magical results. Chronic health issues can slowly disappear, without disruption to your everyday schedule. Big Magic uses the natural Schuman frequency to induce healing. The mat covers large areas like the spine and legs, for extra convenience.

The power consumption of Big Magic is low. You can set up your wonderful Big Magic, then forget it, knowing your health will improve every night.

Pets also benefit from Big Magic. Place the mat under their sleeping pad, so they too can benefit from the naturally-healing waves.

Warning

Never use Big Magic in, near, or around water. Big Magic's magnetic pulses also prohibit its use under the following circumstances:

During pregnancy.

While using a non-MRI-safe IUD.

People or animals with organ transplants.

People or animals with pacemakers, hearing aids, medical pumps, or other electrical implants/devices.